

**Effective Date**  
**December 6, 2021**



### Driver Has No Change

Customers may use a Ventra Card, contactless bankcard, Ventra Ticket, Ride Free or Reduced Fare permit, or cash to pay fares on Pace fixed route services. Reduced fares are available for children (ages 7-11) and high school, junior high and grammar school students (ages 12-20) presenting a valid Ventra Student Riding Permit or valid school I.D. between 5:30am and 8:30pm on school days. Seniors 65 and older, people with disabilities and individuals with a valid Medicare card qualify for reduced fares. A valid RTA Reduced Fare Permit must be presented when using cash to pay a reduced fare. Eligible seniors and people with disabilities may ride fixed route services for free through the RTA Ride Free Program. Please contact the RTA at (312) 913-3110 for more information on free and reduced fares. Free rides are offered to children under 7 (max two children per fare paying adult), law enforcement officers and firefighters in full uniform or presenting a badge, and active duty military personnel in uniform. See the Pace Fare Guide for current fares, passes, restrictions and additional information. Visit [ventrachicago.com](http://ventrachicago.com) or call 877-NOW-VENTRA to purchase and load value and passes onto your Ventra Card.

For travel information:  
**RTA Travel Information Center**  
**(312) 836-7000**

For other information:  
**Pace Customer Relations**  
**(847) 364-PACE (7223)**

### CARRIER INFORMATION

**OPERATED BY: Pace Heritage**  
For lost and found call (815) 723-3259

### ADDITIONAL INFORMATION

The schedules, fares and other information in this timetable are subject to change. Pace does not assume responsibility for errors in timetables, nor for inconvenience or damage resulting from delayed trains or buses or failure to make connections.

**Buses on this route will stop to pick up and drop off passengers only at bus stop signs with the Pace logo and route number. Please wait for the bus at a bus stop sign.**

## 504 South Joliet



**All Pace service is wheelchair accessible.**



All Pace buses on this route are equipped with bike racks. 

## Posted Stops Only

## Major Destinations

## Pace Transit Center

**Amtrak/Metra Heritage Corridor/  
Metra Rock Island District  
Joliet Station**

**Will County Health Department**

## Salem Village

## Certified Warehouse Foods

## Primary Care Joliet

## Laraway Crossings

### Weekday Service

**December 6, 2021**

## WEEKDAY SOUTHBOUND



PACE TRANSIT CENTER	4TH/ CHICAGO/ MCDONOUGH	DAVID/ NEAL	MANHATTAN/ RICHARDS	CHICAGO/ EMERALD	LARAWAY/ CASHEL
6:10AM	6:15AM	6:20AM	6:26AM	6:31AM	6:34AM
7:10	7:15	7:20	7:26	7:31	7:34
8:10	8:15	8:20	8:26	8:31	8:34
9:10	9:15	9:20	9:26	9:31	9:34
10:10	10:15	10:20	10:26	10:32	10:35
11:10	11:15	11:20	11:25	11:32	11:35
<b>12:10PM</b>	<b>12:15PM</b>	<b>12:20PM</b>	<b>12:25PM</b>	<b>12:32PM</b>	<b>12:35PM</b>
<b>1:10</b>	<b>1:15</b>	<b>1:20</b>	<b>1:26</b>	<b>1:32</b>	<b>1:35</b>
<b>2:10</b>	<b>2:15</b>	<b>2:20</b>	<b>2:26</b>	<b>2:32</b>	<b>2:35</b>
<b>3:10</b>	<b>3:15</b>	<b>3:20</b>	<b>3:26</b>	<b>3:32</b>	<b>3:35</b>
<b>4:10</b>	<b>4:15</b>	<b>4:20</b>	<b>4:25</b>	<b>4:31</b>	<b>4:34</b>
<b>5:10</b>	<b>5:15</b>	<b>5:20</b>	<b>5:25</b>	<b>5:31</b>	<b>5:34</b>
<b>6:10</b>	<b>6:15</b>	<b>6:20</b>	<b>6:25</b>	<b>6:31</b>	<b>6:34</b>
<b>7:10</b>	<b>7:15</b>	<b>7:20</b>	<b>7:25</b>	<b>7:32</b>	<b>7:35</b>

## WEEKDAY NORTHBOUND



LARAWAY/ CASHEL	CHICAGO/ EMERALD	MANHATTAN/ RICHARDS	DAVID/ NEAL	4TH/ CHICAGO/ MCDONOUGH	PACE TRANSIT CENTER
5:45AM	5:48AM	5:52AM	5:56AM	6:00AM	6:06AM
6:40	6:43	6:47	6:52	6:57	7:03
7:40	7:43	7:47	7:52	7:57	8:03
8:39	8:42	8:46	8:50	8:55	9:01
9:40	9:43	9:47	9:51	9:56	10:02
10:40	10:43	10:47	10:51	10:56	11:02
11:40	11:43	11:47	11:51	11:56	<b>12:02PM</b>
<b>12:40PM</b>	<b>12:43PM</b>	<b>12:47PM</b>	<b>12:51PM</b>	<b>12:56PM</b>	<b>1:02</b>
<b>1:40</b>	<b>1:43</b>	<b>1:47</b>	<b>1:52</b>	<b>1:57</b>	<b>2:03</b>
<b>2:40</b>	<b>2:43</b>	<b>2:47</b>	<b>2:52</b>	<b>2:57</b>	<b>3:03</b>
<b>3:40</b>	<b>3:43</b>	<b>3:47</b>	<b>3:51</b>	<b>3:56</b>	<b>4:02</b>
<b>4:40</b>	<b>4:43</b>	<b>4:47</b>	<b>4:52</b>	<b>4:57</b>	<b>5:03</b>
<b>5:40</b>	<b>5:43</b>	<b>5:47</b>	<b>5:51</b>	<b>5:56</b>	<b>6:02</b>
<b>6:41</b>	<b>6:44</b>	<b>6:48</b>	<b>6:53</b>	<b>6:58</b>	<b>7:04</b>
<b>7:40</b>	<b>7:43</b>	<b>7:47</b>	<b>7:51</b>	<b>7:56</b>	<b>8:02</b>

**PS** Buses will stop at Posted Stops Only along the entire route.

No Saturday, Sunday or holiday service.

-092421rev-110321rev

# Route 511

Effective Date  
December 6, 2021

Transfer at Pace Transit Center to/from Routes 501, 504, 505, 507, 508, 509, 512, 832, and 834.

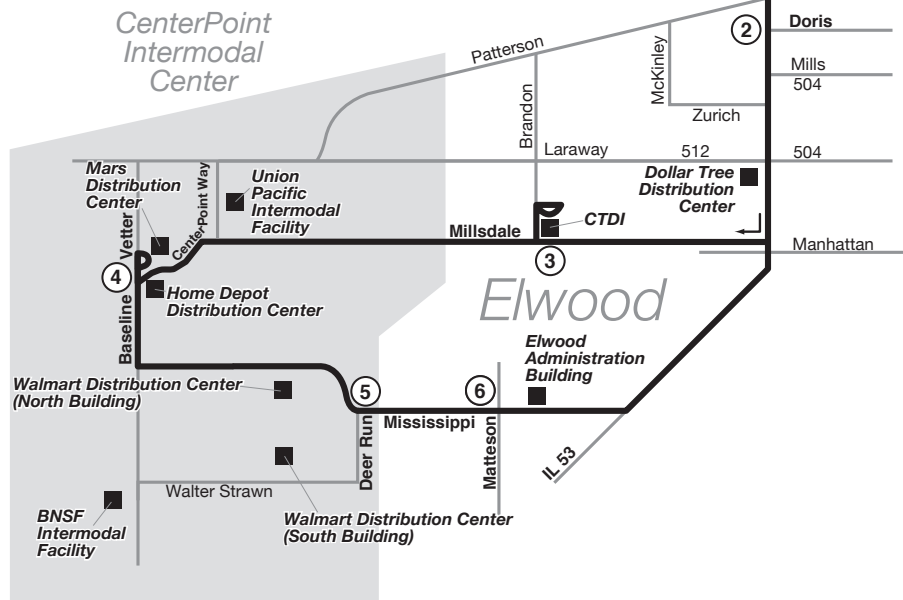
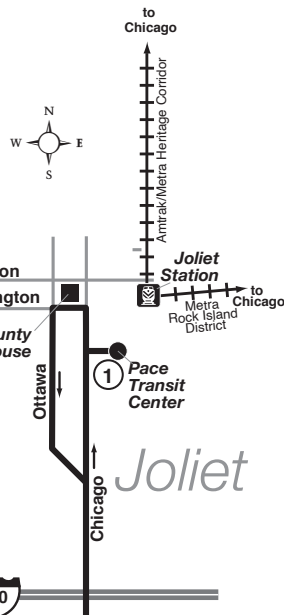

## REGULAR FARE ROUTE

Use your Ventra® Card  
or exact fare in cash.

Driver Has No Change

Customers may use a Ventra Card, contactless bankcard, Ventra Ticket, Ride Free or Reduced Fare permit, or cash to pay fares on Pace fixed route services. Reduced fares are available for children (ages 7-11) and high school, junior high and grammar school students (ages 12-20) presenting a valid Ventra Student Riding Permit or valid school I.D. between 5:30am and 8:30pm on school days. Seniors 65 and older, people with disabilities and individuals with a valid Medicare card qualify for reduced fares. A valid RTA Reduced Fare Permit must be presented when using cash to pay a reduced fare. Eligible seniors and people with disabilities may ride fixed route services for free through the RTA Ride Free Program. Please contact the RTA at (312) 913-3110 for more information on free and reduced fares. Free rides are offered to children under 7 (max two children per fare paying adult), law enforcement officers and firefighters in full uniform or presenting a badge, and active duty military personnel in uniform. See the Pace Fare Guide for current fares, passes, restrictions and additional information. Visit [ventrachicago.com](http://ventrachicago.com) or call 877-NOW-VENTRA to purchase and load value and passes onto your Ventra Card.

### TRAVEL INFORMATION

For travel information:  
RTA Travel Information Center  
(312) 836-7000

For other information:  
Pace Customer Relations  
(847) 364-PACE (7223)

### CARRIER INFORMATION

OPERATED BY: Pace Heritage  
For lost and found call (815) 723-3259

### ADDITIONAL INFORMATION

The schedules, fares and other information in this timetable are subject to change. Pace does not assume responsibility for errors in timetables, nor for inconvenience or damage resulting from delayed trains or buses or failure to make connections.

Unless otherwise noted, bus will stop upon signal to driver at any intersection along the route where it is safe to do so.

# 511

Joliet-Elwood-  
CenterPoint



All Pace service is  
wheelchair accessible.



All Pace buses on this route  
are equipped with bike racks.

## Major Destinations

Pace Transit Center

Amtrak/  
Metra Heritage Corridor  
Metra Rock Island District  
Joliet Station

Elwood

CenterPoint  
Intermodal Center

Weekday Rush Hour Service

December 6, 2021

## WEEKDAY SOUTHBOUND



<b>PACE TRANSIT CENTER</b>	<b>IL 53/ DORIS</b>	<b>MILLSDALE/ BRANDON</b>	<b>CENTERPOINT/ BASELINE</b>	<b>MISSISSIPPI/ DEER RUN</b>
5:05AM	5:10AM	5:20AM	5:26AM	5:40AM
4:00PM	4:07PM	4:17PM	4:23PM	4:37PM

## WEEKDAY NORTHBOUND



<b>MISSISSIPPI/ DEER RUN</b>	<b>MISSISSIPPI/ MATTESON</b>	<b>IL 53/ DORIS</b>	<b>PACE TRANSIT CENTER</b>
5:43AM	5:50AM	6:01AM	6:05AM
4:41PM	4:48PM	4:59PM	5:06PM

Unless otherwise noted, bus will stop upon signal to driver at any intersection along the route where it is safe to do so.

No Saturday, Sunday or holiday service.

# Route 512

Effective Date  
December 6, 2021



Transfer at Pace Transit Center to/from Routes 501, 504, 505, 507, 508, 509, 511, 832, and 834.

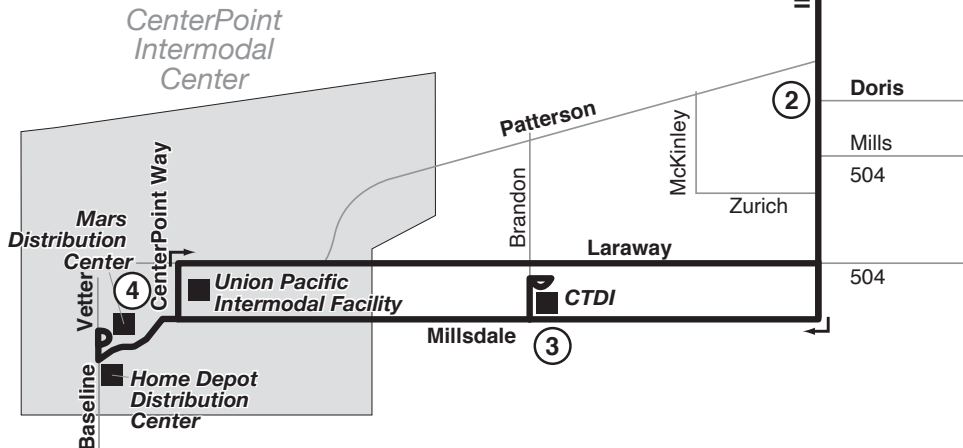
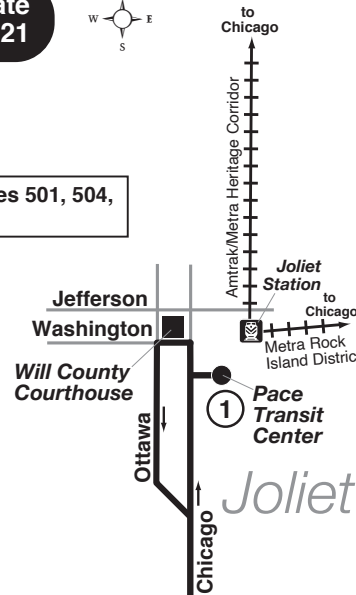

## REGULAR FARE ROUTE

Use your Ventra® Card  
or exact fare in cash.  
Driver Has No Change

Customers may use a Ventra Card, contactless bankcard, Ventra Ticket, Ride Free or Reduced Fare permit, or cash to pay fares on Pace fixed route services. Reduced fares are available for children (ages 7-11) and high school, junior high and grammar school students (ages 12-20) presenting a valid Ventra Student Riding Permit or valid school I.D. between 5:30am and 8:30pm on school days. Seniors 65 and older, people with disabilities and individuals with a valid Medicare card qualify for reduced fares. A valid RTA Reduced Fare Permit must be presented when using cash to pay a reduced fare. Eligible seniors and people with disabilities may ride fixed route services for free through the RTA Ride Free Program. Please contact the RTA at (312) 913-3110 for more information on free and reduced fares. Free rides are offered to children under 7 (max two children per fare paying adult), law enforcement officers and firefighters in full uniform or presenting a badge, and active duty military personnel in uniform. See the Pace Fare Guide for current fares, passes, restrictions and additional information. Visit [ventrachicago.com](http://ventrachicago.com) or call 877-NOW-VENTRA to purchase and load value and passes onto your Ventra Card.

### TRAVEL INFORMATION

For travel information:  
RTA Travel Information Center  
(312) 836-7000

For other information:  
Pace Customer Relations  
(847) 364-PACE (7223)

### CARRIER INFORMATION

OPERATED BY: Pace Heritage  
For lost and found call (815) 723-3259

### ADDITIONAL INFORMATION

The schedules, fares and other information in this timetable are subject to change. Pace does not assume responsibility for errors in timetables, nor for inconvenience or damage resulting from delayed trains or buses or failure to make connections.

Unless otherwise noted, bus will stop upon signal to driver at any intersection along the route where it is safe to do so.

# 512

Joliet-  
CenterPoint



All Pace service is  
wheelchair accessible.



All Pace buses on this route  
are equipped with bike racks.

## Major Destinations

Pace Transit Center

Amtrak/  
Metra HeritageCorridor/  
Metra Rock Island District  
Joliet Station

CenterPoint  
Intermodal Center

Weekday Rush Hour Service

December 6, 2021

PaceBus.com



# ROUTE 512 JOLIET-CENTERPOINT



## WEEKDAY SOUTHBOUND



<b>PACE TRANSIT CENTER</b>	<b>IL 53/ DORIS</b>	<b>MILLSDALE/ BRANDON</b>	<b>CENTERPOINT/ BASELINE</b>
6:30AM	6:35AM	6:45AM	6:51AM

## WEEKDAY NORTHBOUND



<b>CENTERPOINT/ BASELINE</b>	<b>IL 53/ DORIS</b>	<b>PACE TRANSIT CENTER</b>
3:12PM	3:27PM	3:34PM

Unless otherwise noted, bus will stop upon signal to driver at any intersection along the route where it is safe to do so.

No Saturday, Sunday or holiday service.

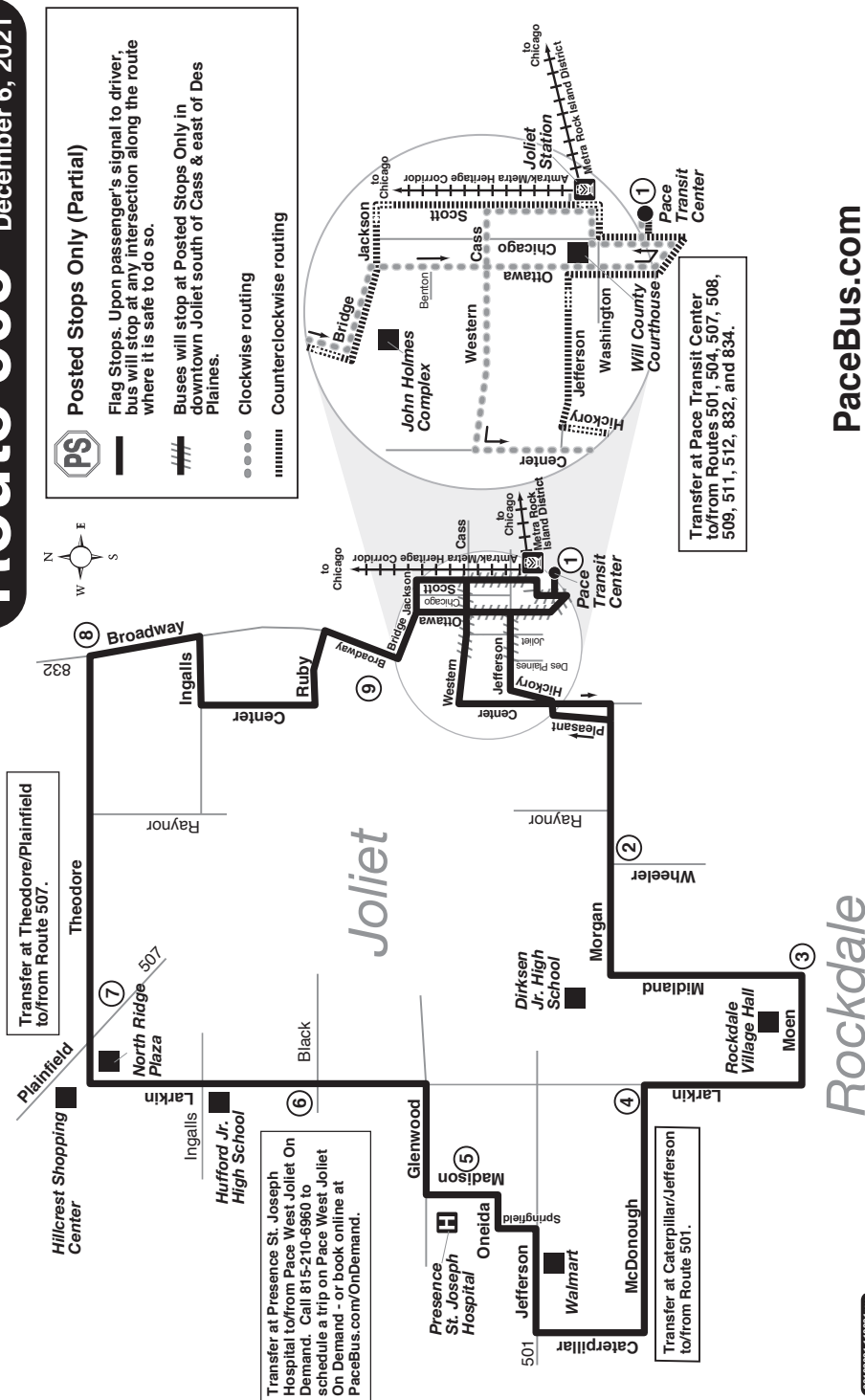

## REGULAR FARE ROUTE

Use your Ventra® Card  
or exact fare in cash.  
Driver Has No Change

Customers may use a Ventra Card, contactless bankcard, Ventra Ticket, Ride Free or Reduced Fare permit, or cash to pay fares on Pace fixed route services. Reduced fares are available for children (ages 7-11) and high school, junior high and grammar school students (ages 12-20) presenting a valid Ventra Student Riding Permit or valid school I.D. between 5:30am and 8:30pm on school days. Seniors 65 and older, people with disabilities and individuals with a valid Medicare card qualify for reduced fares. A valid RTA Reduced Fare Permit must be presented when using cash to pay a reduced fare. Eligible seniors and people with disabilities may ride fixed route services for free through the RTA Ride Free Program. Please contact the RTA at (312) 913-3110 for more information on free and reduced fares. Free rides are offered to children under 7 (max two children per fare paying adult), law enforcement officers and firefighters in full uniform or presenting a badge, and active duty military personnel in uniform. See the Pace Fare Guide for current fares, passes, restrictions and additional information. Visit [ventrachicago.com](http://ventrachicago.com) or call 877-NOW-VENTRA to purchase and load value and passes onto your Ventra Card.

## TRAVEL INFORMATION

For travel information:  
RTA Travel Information Center  
(312) 836-7000

For other information:  
Pace Customer Relations  
(847) 364-PACE (7223)

## CARRIER INFORMATION

OPERATED BY: Pace Heritage  
For lost and found call (815) 723-3259

## ADDITIONAL INFORMATION

The schedules, fares and other information in this timetable are subject to change. Pace does not assume responsibility for errors in timetables, nor for inconvenience or damage resulting from delayed trains or buses or failure to make connections.

Unless otherwise noted, bus will stop upon signal to driver at any intersection along the route where it is safe to do so.

# 505

## West Joliet Loop



All Pace service is wheelchair accessible.



Posted Stops Only (Partial) **PS**

All Pace buses on this route are equipped with bike racks.

## Major Destinations

Pace Transit Center

Amtrak/  
Metra Heritage Corridor/  
Metra Rock Island District  
Joliet Station

Presence  
St. Joseph Hospital

Hufford Jr. High School

North Ridge Plaza

John Holmes Complex

Monday - Saturday Service

## December 6, 2021





# ROUTE 505 • WEST JOLIET LOOP



## WEEKDAY CLOCKWISE



DEPARTS PACE TRANSIT CENTER	MORGAN/ WHEELER	MIDLAND/ MOEN	LARKIN/ MCDONOUGH	ARRIVES ST. JOSEPH HOSPITAL	DEPARTS ST. JOSEPH HOSPITAL	LARKIN/ BLACK	THEODORE/ PLAINFIELD	BROADWAY/ THEODORE	BROADWAY/ BRIDGE	ARRIVES PACE TRANSIT CENTER
-	-	-	-	-	5:38AM	5:41AM	5:45AM	5:49AM	5:55AM	6:00AM
6:10AM	6:18AM	6:22AM	6:26AM	6:36AM	6:39	6:42	6:46	6:50	6:56	7:01
7:10	7:18	7:22	7:26	7:36	7:39	7:42	7:46	7:50	7:56	8:01
8:10	8:18	8:22	8:26	8:36	8:39	8:42	8:46	8:50	8:56	9:01
9:10	9:18	9:22	9:26	9:36	9:39	9:42	9:46	9:50	9:56	10:01
10:10	10:18	10:22	10:26	10:36	10:39	10:42	10:46	10:50	10:56	11:01
11:10	11:18	11:22	11:26	11:36	11:39	11:42	11:46	11:50	11:56	12:01PM
12:10PM	12:18PM	12:22PM	12:26PM	12:36PM	12:39PM	12:42PM	12:46PM	12:50PM	12:56PM	1:01
1:10	1:18	1:22	1:26	1:36	1:39	1:42	1:46	1:50	1:56	2:01
2:10	2:18	2:22	2:26	2:36	2:39	2:42	2:46	2:50	2:56	3:01
3:10	3:18	3:22	3:26	3:36	3:39	3:42	3:46	3:50	3:56	4:01
4:10	4:18	4:22	4:26	4:36	4:39	4:42	4:46	4:50	4:56	5:01
5:10	5:18	5:22	5:26	5:36	5:39	5:42	5:46	5:50	5:56	6:01
6:10	6:18	6:22	6:26	6:36	6:39	6:42	6:46	6:50	6:56	7:01

## WEEKDAY COUNTER CLOCKWISE



DEPARTS PACE TRANSIT CENTER	BROADWAY/ BRIDGE	BROADWAY/ THEODORE	THEODORE/ PLAINFIELD	LARKIN/ BLACK	ARRIVES ST. JOSEPH HOSPITAL	DEPARTS ST. JOSEPH HOSPITAL	LARKIN/ MCDONOUGH	MIDLAND/ MOEN	MORGAN/ WHEELER	ARRIVES PACE TRANSIT CENTER
6:10AM	6:15AM	6:21AM	6:25AM	6:29AM	6:34AM	6:39AM	6:47AM	6:50AM	6:54AM	7:03AM
7:10	7:15	7:21	7:25	7:29	7:34	7:39	7:47	7:50	7:54	8:03
8:10	8:15	8:21	8:25	8:29	8:34	8:39	8:47	8:50	8:54	9:03
9:10	9:15	9:21	9:25	9:29	9:34	9:39	9:47	9:50	9:54	10:03
10:10	10:15	10:21	10:25	10:29	10:34	10:39	10:47	10:50	10:54	11:03
11:10	11:15	11:21	11:25	11:29	11:34	11:39	11:47	11:50	11:54	12:03PM
12:10PM	12:15PM	12:21PM	12:25PM	12:29PM	12:34PM	12:39PM	12:47PM	12:50PM	12:54PM	1:03
1:10	1:15	1:21	1:25	1:29	1:34	1:39	1:47	1:50	1:54	2:03
2:10	2:15	2:21	2:25	2:29	2:34	2:42	2:50	2:53	2:57	3:06
3:10	3:15	3:21	3:25	3:29	3:34	3:39	3:47	3:50	3:54	4:03
4:10	4:15	4:21	4:25	4:29	4:34	4:39	4:47	4:50	4:54	5:03
5:10	5:15	5:21	5:25	5:29	5:34	5:39	5:47	5:50	5:54	6:03
6:10	6:15	6:21	6:25	6:29	6:34	6:39	6:47	6:50	6:54	7:03

## SATURDAY CLOCKWISE



DEPARTS PACE TRANSIT CENTER	MORGAN/ WHEELER	MIDLAND/ MOEN	LARKIN/ MCDONOUGH	ARRIVES ST. JOSEPH HOSPITAL	DEPARTS ST. JOSEPH HOSPITAL	LARKIN/ BLACK	THEODORE/ PLAINFIELD	BROADWAY/ THEODORE	BROADWAY/ BRIDGE	ARRIVES PACE TRANSIT CENTER
10:10AM	10:18AM	10:22AM	10:26AM	10:36AM	10:40AM	10:45AM	10:50AM	10:54AM	10:59AM	11:04AM
11:10	11:18	11:22	11:26	11:36	11:40	11:45	11:50	11:54	11:59	12:04PM
12:10PM	12:18PM	12:22PM	12:26PM	12:36PM	12:40PM	12:45PM	12:50PM	12:54PM	12:59PM	1:04
1:10	1:18	1:22	1:26	1:36	1:40	1:45	1:50	1:54	1:59	2:04
2:10	2:18	2:22	2:26	2:36	2:40	2:45	2:50	2:54	2:59	3:04
3:10	3:18	3:22	3:26	3:36	3:40	3:45	3:50	3:54	3:59	4:04
4:10	4:18	4:22	4:26	4:36	4:40	4:45	4:50	4:54	4:59	5:04
5:10	5:18	5:22	5:26	5:36	-	-	-	-	-	-

## SATURDAY COUNTER CLOCKWISE



DEPARTS PACE TRANSIT CENTER	BROADWAY/ BRIDGE	BROADWAY/ THEODORE	THEODORE/ PLAINFIELD	LARKIN/ BLACK	ARRIVES ST. JOSEPH HOSPITAL	DEPARTS ST. JOSEPH HOSPITAL	LARKIN/ MCDONOUGH	MIDLAND/ MOEN	MORGAN/ WHEELER	ARRIVES PACE TRANSIT CENTER
-	-	-	-	-	-	9:38AM	9:46AM	9:49AM	9:53AM	10:02AM
10:10AM	10:15AM	10:22AM	10:26AM	10:30AM	10:34AM	10:37	10:45	10:48	10:52	11:01
11:10	11:15	11:22	11:26	11:30	11:34	11:37	11:45	11:48	11:52	12:01PM
12:10PM	12:15PM	12:22PM	12:26PM	12:30PM	12:34PM	12:37PM	12:45PM	12:48PM	12:52PM	1:01
1:10	1:15	1:22	1:26	1:30	1:34	1:37	1:45	1:48	1:52	2:01
2:10	2:15	2:22	2:26	2:30	2:34	2:37	2:45	2:48	2:52	3:01
3:10	3:15	3:22	3:26	3:30	3:34	3:37	3:45	3:48	3:52	4:01
4:10	4:15	4:22	4:26	4:30	4:34	4:37	4:45	4:48	4:52	5:01
5:10	5:15	5:22	5:26	5:30	5:34	-	-	-	-	-

**(PS)** Buses will stop at Posted Stops Only in downtown Joliet south of Cass & east of Des Plaines. Elsewhere, bus will stop upon signal to driver at any intersection along the route where it is safe to do so.

No Sunday or holiday service.

©2018 Pace Transit



# Route 509

Effective Date  
December 6, 2021



Todos los autobuses de Pace en esta ruta están equipados con portabicicletas.



El servicio de Pace es accesible para sillas de ruedas.



Buses will stop at Posted Stops Only in downtown Joliet west of Scott.  
Los autobuses solamente pararán por Paradas Asignadas en el centro de Joliet al oeste de Scott.



Flag Stops. Upon passenger's signal to driver, bus will stop at any intersection along the route where it is safe to do so. Al hacerle señal al conductor, el autobús parará en cualquier intersección a lo largo de la ruta siempre y cuando sea un lugar seguro para parar.



Posted Stops Only. Bus will stop to pick up and drop off passengers only at bus stop signs with the Pace logo and route number. Please wait for the bus at a bus stop sign. Solamente paradas asignadas. El autobús solamente parará a recoger o bajar a pasajeros donde se encuentra la parada asignada con el logo de Pace y el número de la ruta. Por favor espere al bus por el rotulo de parada del autobús.



When Green Garden is closed in front of Fairmont School, bus will detour as shown. Cuando Green Garden este cerrado en frente de Fairmont School, el autobús desviará como indicado.



Certain trips only. See schedule. Algunos viajes solamente. Consulte el horario.

## Fairmont

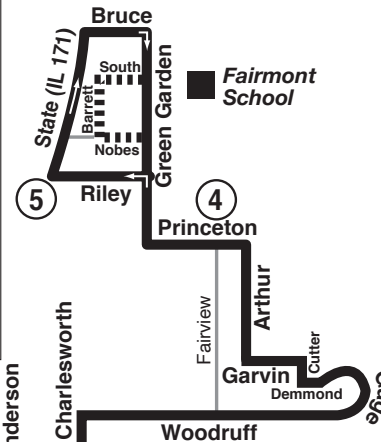

Williamson  
Meeker

3

Henderson

Charlesworth

Fairview

Woodruff

Williamson

Meeker

3

Henderson

Charlesworth

Fairview

Woodruff

Williamson

Meeker

3

Henderson

Charlesworth

Fairview

Woodruff

Williamson

Meeker

3

Henderson

Charlesworth

Fairview

Woodruff

Williamson

Meeker

3

Henderson

Charlesworth

Fairview

Woodruff

Williamson

Meeker

3

Henderson

Charlesworth

Fairview

Woodruff

Williamson

Meeker

3

Henderson

Charlesworth

Fairview

Woodruff

Williamson

Meeker

3

Henderson

Charlesworth

Fairview

Woodruff

Williamson

Meeker

3

Henderson

Charlesworth

Fairview

Woodruff

Williamson

Meeker

3

Henderson

Charlesworth

Fairview

Woodruff

Williamson

Meeker

3

Henderson

Charlesworth

Fairview

Woodruff

Williamson

Meeker

3

Henderson

Charlesworth

Fairview

Woodruff

Williamson

Meeker

3

Henderson

Charlesworth

Fairview

Woodruff

Williamson

Meeker

3

Henderson

Charlesworth

Fairview

Woodruff

Williamson

Meeker

3

Henderson

Charlesworth

Fairview

Woodruff

Williamson

Meeker

3

Henderson

Charlesworth

Fairview

Woodruff

Williamson

Meeker

3

Henderson

Charlesworth

Fairview

Woodruff

Williamson

Meeker

3

Henderson

Charlesworth

Fairview

Woodruff

Williamson

Meeker

3

Henderson

Charlesworth

Fairview

Woodruff

Williamson

Meeker

3

Henderson

Charlesworth

Fairview

Woodruff

Williamson

Meeker

3

Henderson

Charlesworth

Fairview

Woodruff

Williamson

Meeker

3

Henderson

Charlesworth

Fairview

Woodruff

Williamson

Meeker

3

Henderson

Charlesworth

Fairview

Woodruff

Williamson

Meeker

3

Henderson

Charlesworth

Fairview

Woodruff

Williamson

Meeker

3

Henderson

Charlesworth

Fairview

Woodruff

Williamson

Meeker

3

Henderson

Charlesworth

Fairview

Woodruff

Williamson

Meeker

3

Henderson

Charlesworth

Fairview

Woodruff

Williamson

Meeker

3

Henderson

Charlesworth

Fairview

Woodruff

Williamson

Meeker

3

Henderson

Charlesworth

Fairview

Woodruff

Williamson

Meeker

3

Henderson

Charlesworth

Fairview

Woodruff

Williamson

Meeker

3

Henderson

Charlesworth

Fairview

Woodruff

Williamson

Meeker

3

Henderson

Charlesworth

Fairview

Woodruff

Williamson

Meeker

3

Henderson

Charlesworth

Fairview

Woodruff

Williamson

Meeker

3

Henderson

Charlesworth

Fairview

Woodruff

Williamson

Meeker

3

Henderson

Charlesworth

Fairview

Woodruff

Williamson

Meeker

3

Henderson

Charlesworth

Fairview

Woodruff

Williamson

Meeker

3

Henderson

Charlesworth

Fairview

Woodruff

Williamson

Meeker

3

Henderson

Charlesworth

Fairview

Woodruff

Williamson

Meeker

3

Henderson

Charlesworth

Fairview

Woodruff

Williamson

Meeker

3

Henderson

Charlesworth



# ROUTE 509 JOLIET-FAIRMONT



## WEEKDAY EASTBOUND

ENTRE SEMANA HACIA EL ESTE



PACE TRANSIT CENTER	JACKSON/ COLLINS	HENDERSON/ MEEKER	PRINCETON/ FAIRVIEW	STATE/ RILEY
-	-	-	4:55AM	4:58AM
6:10AM B	-	6:19AM	6:29	6:32
7:10	7:15AM	7:18	7:28	7:31
8:10 B	-	8:19	8:29	8:32
9:10	9:15	9:18	9:28	9:31
10:10	10:15	10:18	10:28	10:31
11:10	11:15	11:18	11:28	11:31
12:10PM B	-	12:19PM	12:29PM	12:32PM
1:10	1:15PM	1:18	1:28	1:31
2:10	2:15	2:18	2:28	2:31
3:10 B	-	3:19	3:29	3:32
4:10	4:15	4:18	4:28	4:31
5:10	5:15	5:18	5:28	5:31
6:10	6:15	6:18	6:28	6:31
7:10	7:15	7:18	7:28	7:31
8:10	8:15	8:18	8:28	8:31
9:10 B	-	9:19	9:29	9:32
10:23	10:28	10:31	10:41	10:44

## WEEKDAY WESTBOUND

ENTRE SEMANA HACIA EL OESTE



STATE/ RILEY	PRINCETON/ FAIRVIEW	HENDERSON/ MEEKER	JACKSON/ COLLINS	PACE TRANSIT CENTER
4:58AM	5:04AM	5:13AM B	-	5:23AM
5:41	5:47	5:57	6:00AM	6:06
6:36	6:42	6:52 B	-	7:01
7:36	7:42	7:52	7:55	8:01
8:36	8:42	8:52 B	-	9:02
9:36	9:42	9:51	9:54	10:01
10:36	10:42	10:51	10:54	11:01
11:36	11:42	11:51	11:54	12:01PM
12:36PM	12:42PM	12:51PM	12:54PM	1:01
1:36	1:42	1:51 B	-	2:01
2:36	2:42	2:51	2:54	3:01
3:36	3:42	3:51	3:55	4:02
4:36	4:42	4:51 B	-	5:01
5:36	5:42	5:51	5:55	6:02
6:36	6:42	6:51	6:54	7:01
7:33	7:39	7:48	7:51	7:58
8:33	8:39	8:48	8:51	8:58
9:33	9:39	9:48 B	-	9:58

## SATURDAY EASTBOUND

SÁBADO HACIA EL ESTE



PACE TRANSIT CENTER	JACKSON/ COLLINS	HENDERSON/ MEEKER	PRINCETON/ FAIRVIEW	STATE/ RILEY
10:10AM B	-	10:19AM	10:29AM	10:32AM
11:10	11:15AM	11:18	11:28	11:31
12:10PM B	-	12:19PM	12:29PM	12:32PM
1:10	1:15PM	1:18	1:28	1:31
2:10	2:15	2:18	2:28	2:31
3:10 B	-	3:19	3:29	3:32
4:10	4:15	4:18	4:28	4:31
5:10	5:15	5:18	5:28	5:31
6:10	6:15	6:18	6:28	6:31
7:10	7:15	7:18	7:28	7:31
8:10	8:15	8:18	8:28	8:31
9:10 B	-	9:19	9:29	9:32
10:05	10:10	10:13	10:22	10:25

## SATURDAY WESTBOUND

SÁBADO HACIA EL OESTE



STATE/ RILEY	PRINCETON/ FAIRVIEW	HENDERSON/ MEEKER	JACKSON/ COLLINS	PACE TRANSIT CENTER
8:39AM	8:45AM	8:55AM B	-	9:04AM
9:39	9:45	9:55	9:58AM	10:04
10:39	10:45	10:55	10:58	11:04
11:39	11:45	11:55	11:58	12:04PM
12:39PM	12:45PM	12:55PM	12:58PM	1:04
1:39	1:45	1:55 B	-	2:04
2:39	2:45	2:55	2:58	3:04
3:39	3:45	3:55	3:58	4:04
4:39	4:45	4:55 B	-	5:04
5:39	5:45	5:55	5:58	6:04
6:39	6:45	6:55	6:58	7:04
7:39	7:45	7:55	7:58	8:04
8:39	8:45	8:55 B	-	9:04

**(PS)** Buses will stop at Posted Stops Only in downtown Joliet west of Scott. Elsewhere, bus will stop upon signal to driver at any intersection along the route where it is safe to do so.

**B** - Trip serves Cass between Collins and Henderson and Henderson between Cass and Jackson.

**No Sunday or holiday service.**

**(PS)** Los autobuses solamente pararán por Paradas Asignadas en el centro de Joliet al oeste de Scott. Fuera de esa área, el autobús parará al hacerle señal al conductor en cualquier intersección a lo largo de la ruta, siempre y cuando sea un lugar seguro para parar.

**B** - Viaje con servicio a Cass entre Collins y Henderson y Henderson entre Cass y Jackson.

**No servicio los Domingos o días de feriados.**

# Route 507

Effective Date  
December 6, 2021



## Posted Stops Only

Buses on this route will stop to pick up and drop off passengers only at bus stop signs with the Pace logo and route number. Please wait for the bus at a bus stop sign.

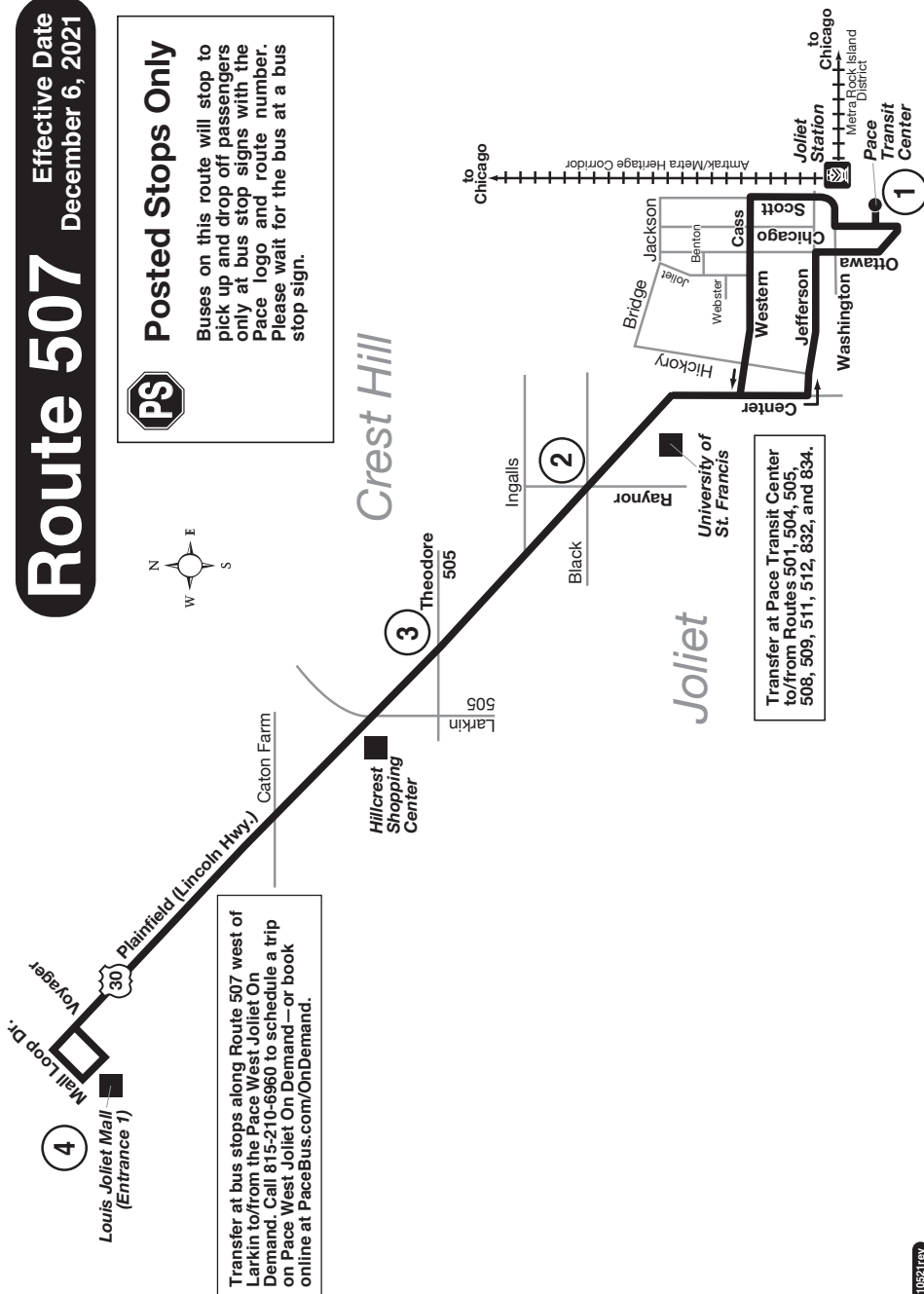

## REGULAR FARE ROUTE

Use your Ventra® Card  
or exact fare in cash.  
Driver Has No Change

Customers may use a Ventra Card, contactless bankcard, Ventra Ticket, Ride Free or Reduced Fare permit, or cash to pay fares on Pace fixed route services. Reduced fares are available for children (ages 7-11) and high school, junior high and grammar school students (ages 12-20) presenting a valid Ventra Student Riding Permit or valid school I.D. between 5:30am and 8:30pm on school days. Seniors 65 and older, people with disabilities and individuals with a valid Medicare card qualify for reduced fares. A valid RTA Reduced Fare Permit must be presented when using cash to pay a reduced fare. Eligible seniors and people with disabilities may ride fixed route services for free through the RTA Ride Free Program. Please contact the RTA at (312) 913-3110 for more information on free and reduced fares. Free rides are offered to children under 7 (max two children per fare paying adult), law enforcement officers and firefighters in full uniform or presenting a badge, and active duty military personnel in uniform. See the Pace Fare Guide for current fares, passes, restrictions and additional information. Visit [ventrachicago.com](http://ventrachicago.com) or call 877-NOW-VENTRA to purchase and load value and passes onto your Ventra Card.

### TRAVEL INFORMATION

For travel information:  
**RTA Travel Information Center**  
(312) 836-7000

For other information:  
**Pace Customer Relations**  
(847) 364-PACE (7223)

### CARRIER INFORMATION

**OPERATED BY: Pace Heritage**  
**For lost and found call (815) 723-3259**

### ADDITIONAL INFORMATION

The schedules, fares and other information in this timetable are subject to change. Pace does not assume responsibility for errors in timetables, nor for inconvenience or damage resulting from delayed trains or buses or failure to make connections.



## Posted Stops Only

Buses on this route will stop to pick up and drop off passengers only at bus stop signs with the Pace logo and route number. Please wait for the bus at a bus stop sign.

# 507 Plainfield



All Pace service is wheelchair accessible.



All Pace buses on this route are equipped with bike racks.

## Posted Stops Only



## Major Destinations

**Pace Transit Center**

**Amtrak/Metra  
Heritage Corridor/  
Metra Rock Island District  
Joliet Station**

**University of St. Francis**

**Hillcrest Shopping  
Center**

**Louis Joliet Mall**

**Monday - Saturday Service**

**December 6, 2021**

**PaceBus.com**

-092421rev110521rev

WEEKDAY EASTBOUND

4

3

2

1

LOUIS JOLIET MALL	PLAINFIELD/ THEODORE	PLAINFIELD/ RAYNOR	PACE TRANSIT CENTER
5:39AM	5:48AM	5:53AM	6:00AM
6:39	6:48	6:53	7:00
7:39	7:48	7:53	8:00
8:39	8:48	8:53	9:00
9:39	9:49	9:54	10:01
10:39	10:49	10:54	11:01
11:39	11:49	11:54	12:01PM
12:39PM	12:49PM	12:54PM	1:01
1:39	1:49	1:54	2:01
2:39	2:49	2:54	3:01
3:39	3:49	3:54	4:01
4:39	4:49	4:54	5:01
5:39	5:49	5:54	6:01
6:39	6:48	6:53	7:00
7:39	7:48	7:53	8:00
8:39	8:48	8:53	9:00
9:39	9:48	9:53	10:00

WEEKDAY WESTBOUND

1

2

3

4

PACE TRANSIT CENTER	PLAINFIELD/ RAYNOR	PLAINFIELD/ THEODORE	LOUIS JOLIET MALL
6:10AM	6:17AM	6:21AM	6:31AM
7:10	7:17	7:21	7:31
8:10	8:17	8:21	8:31
9:10	9:18	9:22	9:32
10:10	10:18	10:22	10:32
11:10	11:18	11:22	11:32
12:10PM	12:18PM	12:22PM	12:32PM
1:10	1:18	1:22	1:32
2:10	2:18	2:22	2:32
3:10	3:18	3:22	3:32
4:10	4:18	4:22	4:32
5:10	5:18	5:22	5:32
6:10	6:17	6:21	6:31
7:10	7:17	7:21	7:31
8:10	8:17	8:21	8:31
9:10	9:17	9:21	9:31

SATURDAY EASTBOUND

4

3

2

1

LOUIS JOLIET MALL	PLAINFIELD/ THEODORE	PLAINFIELD/ RAYNOR	PACE TRANSIT CENTER
9:43AM	9:53AM	9:58AM	10:05AM
10:43	10:53	10:58	11:05
11:43	11:53	11:58	12:05PM
12:43PM	12:53PM	12:58PM	1:05
1:43	1:53	1:58	2:05
2:43	2:53	2:58	3:05
3:43	3:53	3:58	4:05
4:43	4:53	4:58	5:05
5:43	5:53	5:58	6:05
6:43	6:53	6:58	7:05
7:40	7:50	7:55	8:02
8:37	8:47	8:52	8:59
9:27	9:37	9:42	9:49

SATURDAY WESTBOUND

1

2

3

4

PACE TRANSIT CENTER	PLAINFIELD/ RAYNOR	PLAINFIELD/ THEODORE	LOUIS JOLIET MALL
9:10AM	9:18AM	9:22AM	9:32AM
10:10	10:18	10:22	10:32
11:10	11:18	11:22	11:32
12:10PM	12:18PM	12:22PM	12:32PM
1:10	1:18	1:22	1:32
2:10	2:18	2:22	2:32
3:10	3:18	3:22	3:32
4:10	4:18	4:22	4:32
5:10	5:18	5:22	5:32
6:10	6:18	6:22	6:32
7:10	7:18	7:22	7:32
8:07	8:15	8:19	8:29
9:04	9:12	9:16	9:26

**PS** Posted Stops only. Buses will stop at Posted Stops Only along the entire route.

No Sunday or holiday service.

# Route 501

Effective Date  
December 6, 2021



Joliet

●●●●● Certain trips only.  
See schedule.

Shorewood

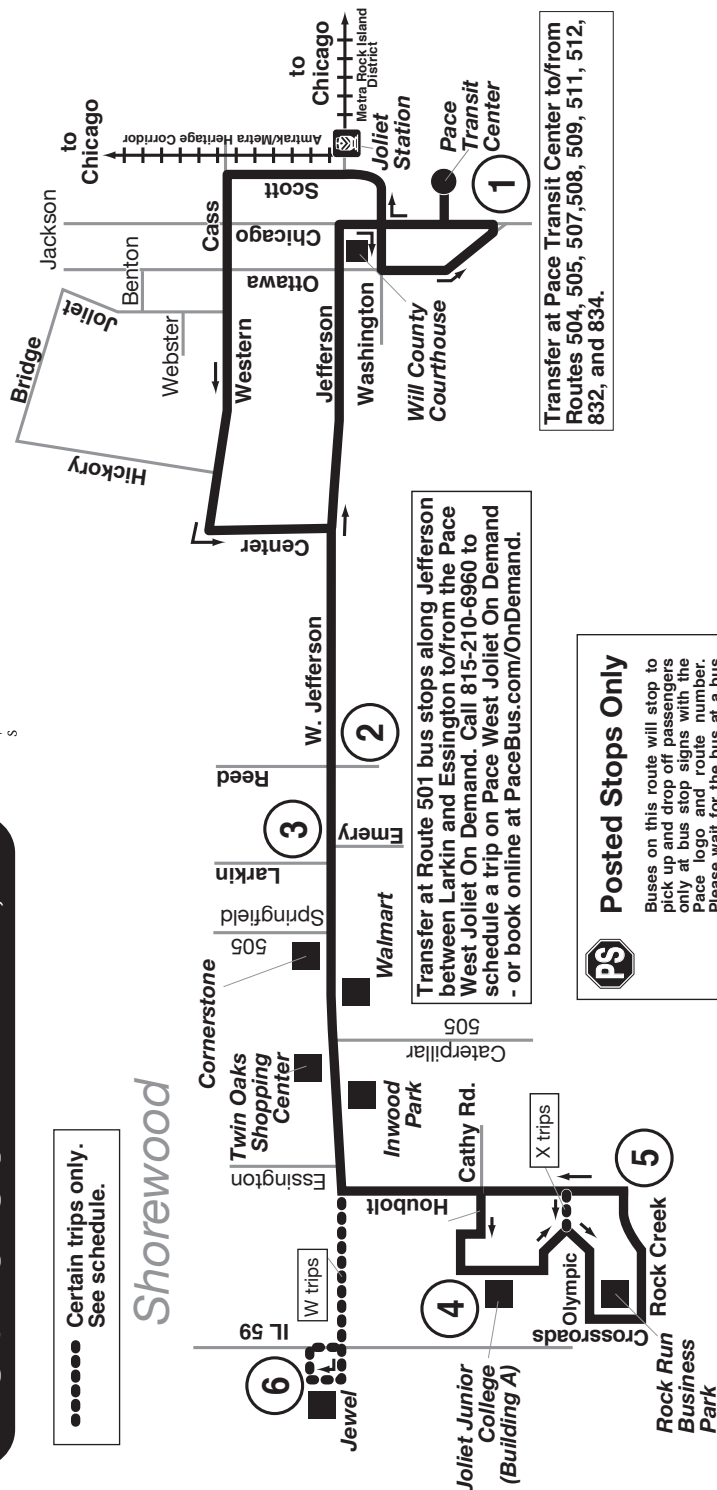

Transfer at Pace Transit Center to/from  
Routes 504, 505, 507, 508, 509, 511, 512,  
832, and 834.

Transfer at Route 501 bus stops along Jefferson  
between Larkin and Essington. Call 815-210-6960 to  
schedule a trip on Pace West Joliet On Demand.  
- or book online at PaceBus.com/OnDemand.

**Posted Stops Only**

Buses on this route will stop to  
pick up and drop off passengers  
only at bus stop signs with the  
Pace logo and route number.  
Please wait for the bus at a bus  
stop sign.

## REGULAR FARE ROUTE

Use your Ventra® Card  
or exact fare in cash.  
Driver Has No Change

Customers may use a Ventra Card, contactless bankcard, Ventra Ticket, Ride Free or Reduced Fare permit, or cash to pay fares on Pace fixed route services. Reduced fares are available for children (ages 7-11) and high school, junior high and grammar school students (ages 12-20) presenting a valid Ventra Student Riding Permit or valid school I.D. between 5:30am and 8:30pm on school days. Seniors 65 and older, people with disabilities and individuals with a valid Medicare card qualify for reduced fares. A valid RTA Reduced Fare Permit must be presented when using cash to pay a reduced fare. Eligible seniors and people with disabilities may ride fixed route services for free through the RTA Ride Free Program. Please contact the RTA at (312) 913-3110 for more information on free and reduced fares. Free rides are offered to children under 7 (max two children per fare paying adult), law enforcement officers and firefighters in full uniform or presenting a badge, and active duty military personnel in uniform. See the Pace Fare Guide for current fares, passes, restrictions and additional information. Visit [ventrachicago.com](http://ventrachicago.com) or call 877-NOW-VENTRA to purchase and load value and passes onto your Ventra Card.

### TRAVEL INFORMATION

For travel information:  
RTA Travel Information Center  
(312) 836-7000

For other information:  
Pace Customer Relations  
(847) 364-PACE (7223)

### CARRIER INFORMATION

**OPERATED BY: Pace Heritage**  
For lost and found call (815) 723-3259

### ADDITIONAL INFORMATION

The schedules, fares and other information in this timetable are subject to change. Pace does not assume responsibility for errors in timetables, nor for inconvenience or damage resulting from delayed trains or buses or failure to make connections.



## Posted Stops Only

Buses on this route will stop to  
pick up and drop off passengers  
only at bus stop signs with the  
Pace logo and route number.  
Please wait for the bus at a bus  
stop sign.

[PaceBus.com](http://PaceBus.com)

501

West  
Jefferson



All Pace service is  
wheelchair accessible.



pace

All Pace buses on this route  
are equipped with bike racks.

Posted Stops Only



## Major Destinations

Pace Transit Center

Amtrak/  
Metra Heritage Corridor/  
Metra Rock Island District  
Joliet Station

Will County Courthouse

Cornerstone

Joliet Junior College

Rock Run Business Park

Monday - Saturday Service

December 6, 2021





# ROUTE 501 WEST JEFFERSON



## WEEKDAY EASTBOUND



189 BROOK FOREST AVE	ROCK CREEK/ HOUBOLT	JEFFERSON/ LARKIN (AT EMERY)	JEFFERSON/ REED	PACE TRANSIT CENTER
-	5:45AM	5:56AM	5:59AM	6:06AM
-	6:45	6:56	6:59	7:06
7:08AM	-	7:17	7:20	7:27
-	7:45	7:56	7:59	8:06
8:08	-	8:17	8:20	8:27
-	8:43	8:54	8:57	9:04
9:08	-	9:18	9:21	9:28
-	9:43	9:54	9:57	10:04
10:09	-	10:19	10:22	10:29
-	10:43	10:54	10:57	11:04
11:09	-	11:21	11:24	11:31
-	11:43	11:54	11:57	12:04PM
12:09PM	-	12:21PM	12:24PM	12:31
-	12:43PM	12:54	12:57	1:04
1:09	-	1:21	1:24	1:31
-	1:43	1:54	1:57	2:04
2:09	-	2:21	2:24	2:31
-	2:43	2:55	2:58	3:05
3:09	-	3:21	3:24	3:31
-	3:43	3:55	3:58	4:06
4:09	-	4:21	4:24	4:33
-	4:43	4:55	4:58	5:07
5:09	-	5:21	5:24	5:33
-	5:43	5:54	5:57	6:06
-	6:43	6:53	6:56	7:03
-	7:43	7:53	7:56	8:03
-	8:43	8:53	8:56	9:03
-	10:02 J	10:12	10:15	10:22

## SATURDAY EASTBOUND



ROCK CREEK/ HOUBOLT	JEFFERSON/ LARKIN (AT EMERY)	JEFFERSON/ REED	PACE TRANSIT CENTER
9:44AM	9:56AM	9:59AM	10:06AM
10:44	10:56	10:59	11:06
11:44	11:56	11:59	12:06PM
12:44PM	12:56PM	12:59PM	1:06
1:40	1:52	1:55	2:02
2:40	2:52	2:55	3:02
3:40	3:52	3:55	4:02
4:40	4:52	4:55	5:02
5:40	5:52	5:55	6:02
6:40	6:52	6:55	7:02
7:40	7:52	7:55	8:02
8:37	8:49	8:52	8:59
9:38	9:50	9:53	10:00

## WEEKDAY WESTBOUND



PACE TRANSIT CENTER	JEFFERSON/ REED	JEFFERSON/ LARKIN	JOLIET JUNIOR COLLEGE	ROCK CREEK/ HOUBOLT	189 BROOK FOREST AVE
6:10AM	6:17AM	6:20AM	6:31AM	6:37AM	-
6:40	6:47	6:50	-	-	7:00AM
7:10	7:17	7:20	7:31	7:37	-
7:40	7:47	7:50	-	-	8:00
8:10	8:17	8:20	8:32	8:38	-
8:40	8:47	8:50	-	-	9:00
9:10	9:17	9:20	9:32	-	-
9:40	9:47	9:50	-	-	10:01
10:10	10:17	10:20	10:33	10:39	-
10:40	10:47	10:50	-	-	-
11:10	11:17	11:20	11:33	11:39	-
11:40	11:47	11:50	-	-	12:01PM
12:10PM	12:17PM	12:20PM	12:33PM	12:39PM	-
12:40	12:47	12:50	-	-	1:01
1:10	1:17	1:20	1:33	1:39	-
1:40	1:47	1:50	-	-	2:01
2:10	2:17	2:20	2:33	2:39	-
2:40	2:47	2:50	-	-	3:01
3:10	3:17	3:20	3:33	3:39	-
3:40	3:47	3:50	-	-	4:01
4:10	4:17	4:20	4:33	4:39	-
4:40	4:47	4:50	-	-	5:01
5:10	5:17	5:20	5:33	5:39	-
6:10	6:17	6:20	6:33	6:39	-
7:10	7:17	7:20	7:33	7:39	-
8:10	8:17	8:20	8:33	8:39	-
9:10	9:17	9:20	9:33	9:39	-

## SATURDAY WESTBOUND



PACE TRANSIT CENTER	JEFFERSON/ REED	JEFFERSON/ LARKIN	JOLIET JUNIOR COLLEGE	ROCK CREEK/ HOUBOLT
9:10AM	9:17AM	9:20AM	9:34AM	9:40AM
10:10	10:17	10:20	10:34	10:40
11:10	11:17	11:20	11:34	11:40
12:10PM	12:17PM	12:20PM	12:34PM	12:40PM
1:10	1:17	1:20 X	-	1:35
2:10	2:17	2:20 X	-	2:35
3:10	3:17	3:20 X	-	3:35
4:10	4:17	4:20 X	-	4:35
5:10	5:17	5:20 X	-	5:35
6:10	6:17	6:20 X	-	6:35
7:10	7:17	7:20 X	-	7:35
8:07	8:14	8:17 X	-	8:32
9:04	9:11	9:14 X	-	9:29

Posted Stops only. Buses will stop at Posted Stops Only along the entire route.

J - Trip serves Joliet Junior College at 10:04 pm.  
X - Trip bypasses Joliet Junior College.

No service on Sundays or holidays.